

MANITOWOC I-43 TECHNOLOGY & ENTERPRISE CAMPUS

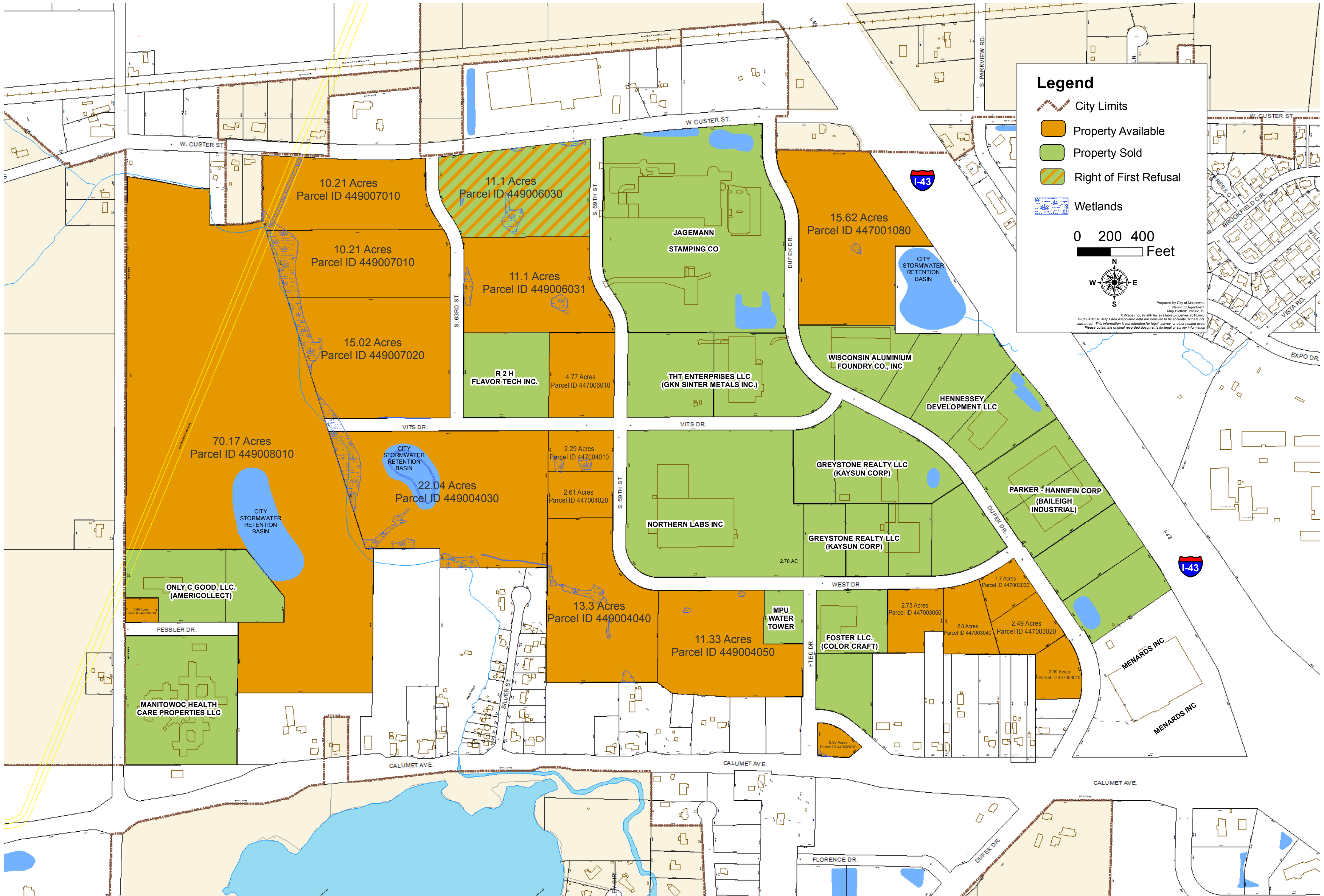

10.21 Acres
Parcel ID 449007010

11.1 Acres
Parcel ID 449006030

15.62 Acres
Parcel ID 447001080

10.21 Acres
Parcel ID 449007010

11.1 Acres
Parcel ID 449006031

JAGEMANN
STAMPING CO

15.02 Acres
Parcel ID 449007020

R 2 H
FLAVOR TECH INC. 4.77 Acres
Parcel ID 447006010

THT ENTERPRISES LLC
(GKN SINTER METALS INC.)

WISCONSIN ALUMINIUM
FOUNDRY CO., INC

HENNESSEY
DEVELOPMENT LLC

70.17 Acres
Parcel ID 449008010

22.04 Acres
Parcel ID 449004030

2.29 Acres
Parcel ID 447004010

2.61 Acres
Parcel ID 447004020

NORTHERN LABS INC

GREYSTONE REALTY LLC
(KAYSUN CORP)

PARKER - HANNIFIN CORP
(BAILEIGH INDUSTRIAL)

ONLY C GOOD, LLC.
(AMERICOLLECT)

13.3 Acres
Parcel ID 449004040

MPU
WATER TOWER

GREYSTONE REALTY LLC
(KAYSUN CORP)

FOSTER LLC.
(COLOR CRAFT)

2.73 Acres
Parcel ID 447003050

1.7 Acres
Parcel ID 447003030

2.8 Acres
Parcel ID 447003040

2.49 Acres
Parcel ID 447003020

2.09 Acres
Parcel ID 447003010

MENARDS INC

MENARDS INC

MANITOWOC HEALTH
CARE PROPERTIES LLC

11.33 Acres
Parcel ID 449004050

0.93 Acres
Parcel ID 449003010

CALUMET AVE.

FLORENCE DR.

DUFEEK DR.

CALUMET AVE.

CALUMET AVE.