

WISCONSIN  
STATE HIGHWAY COMMISSION  
TRAFFIC DEPARTMENT  
VEHICLE VOLUME COUNT  
GRAPHIC SUMMARY SHEET  
FIGURE I

DATE March 21, 06 DAY Tuesday WEATHER Sunny TIME 6:00 AM TO 10:00 PM  
LOCATION: DISTRICT \_\_\_\_\_ COUNTY Manitowish RURAL \_\_\_\_\_ CITY Manitowish  
INTERSECTION Memsha Ave. AND Waldo Blvd.

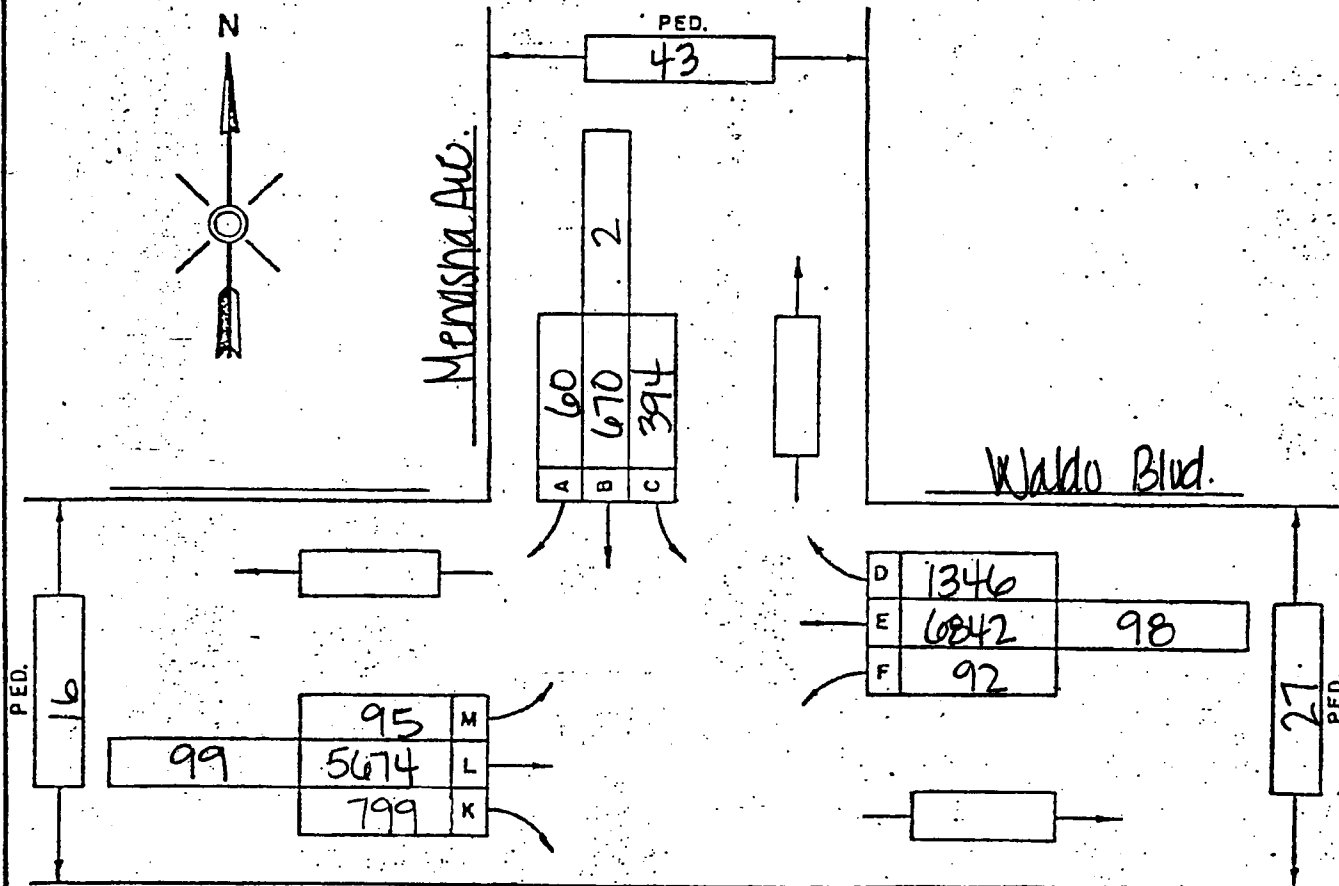

PEDESTRIANS: 22

Total Cars + Pedestrians:  
16,082

Total Trucks:  
199