

WISCONSIN
STATE HIGHWAY COMMISSION
TRAFFIC DEPARTMENT
VEHICLE VOLUME COUNT
GRAPHIC SUMMARY SHEET
FIGURE I

DATE MARCH 3, 05 DAY Thursday WEATHER 30's Cloudy TIME 1am TO 10pm
LOCATION: DISTRICT _____ COUNTY Manitowoc RURAL _____ CITY X
INTERSECTION N. 8th St. AND Waldo Blvd.

OBSERVERS DPW Workers

SHEET _____ OF _____

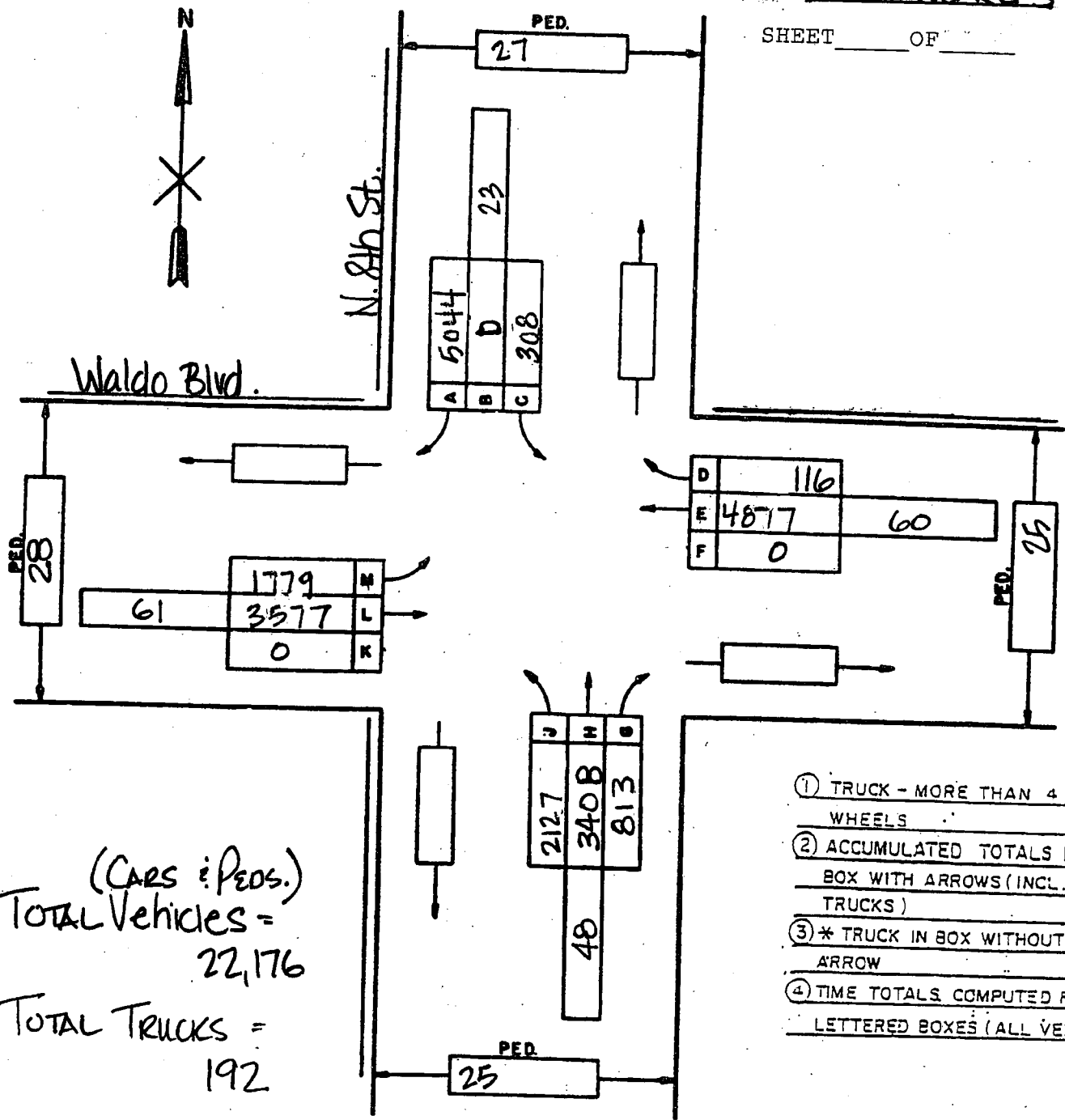

- ① TRUCK - MORE THAN 4 WHEELS
- ② ACCUMULATED TOTALS IN BOX WITH ARROWS (INCL. TRUCKS)
- ③ * TRUCK IN BOX WITHOUT ARROW
- ④ TIME TOTALS COMPUTED FROM LETTERED BOXES (ALL VEH.)

(CARS & PEOS.)
TOTAL VEHICLES = 22,176
TOTAL TRUCKS = 192