



General Requirements

BASIC CODE REQUIREMENTS.

This handout is intended to provide general requirements as defined in Wisconsin Uniform Building Code Section 30.40 Chapter V. and Manitowoc Municipal Code Section 16.350(4). If you have additional questions please contact the department.

LOCATION.

Front Yard. Prohibited.

Side and Rear Yard. Minimum of (5) feet setback from the side and rear yard property line unless easement widths are greater.

Wall, Fence, Other Structures. Minimum of (4) feet setback from any wall, fence, or other structure.

ACCESS.

Fence. A fence or solid structure of not less than (48) inches in height shall completely enclose the pool. A fence is not required around an above ground pool where the pool wall is at least (48) inches above grade for the full pool perimeter. The finished grade shall be maintained for a minimum of (4) feet beyond the outside perimeter of the pool. Openings in the fence shall not allow passage of a (4) inch diameter sphere.

Gates, Doors. All gates or doors opening through such enclosure shall be kept securely closed at all times while unattended and shall be equipped with a self-closing and self-latching device designed capable of keeping such door or gate securely closed. Latches shall be located at least three (3) feet above the ground, accessible deck or stairs.

Ladders, Steps, Other Access. When not completely fenced, all ladders, steps, pool pump/filter equipment or other means of access to an above ground pool shall be removed and/or designed to prevent access when the pool is unattended.

Spas. Spas shall be made inaccessible by a locking safety cover or other approved safety barrier when not in use.

DECKS. All decks require a permit and shall be constructed in accordance with the Uniform Building Code.

ELECTRICAL. All wiring for pools and spas requires a permit and shall be installed by a licensed Electrical Contractor per MMC 18.090(1)(b) & in accordance with the National Electrical Code and/or state and local code.

Permit Application and Inspections

PERMIT. A Pool Permit shall be obtained for:

- All above ground pools - except readily moveable wading pools with a depth of less than (2) feet
- All temporary or permanent air inflatable pools with a sidewall height greater than (2) feet above grade
- All in-ground pools
- All public pools
- All outdoor spas

SITE PLAN. One copy of a site plan is required. A scaled drawing may also be acceptable. Please illustrate existing structures (building and fences) and the proposed pool location, setbacks, and dimensions.

INSPECTIONS. Please call at least (24) hours prior to scheduling an inspection.



Building Inspection Department
900 Quay St, Manitowoc, WI 54220



(920) 686-6940



buildinginspection@manitowoc.org



(800) 242-8511

Site Plan Example

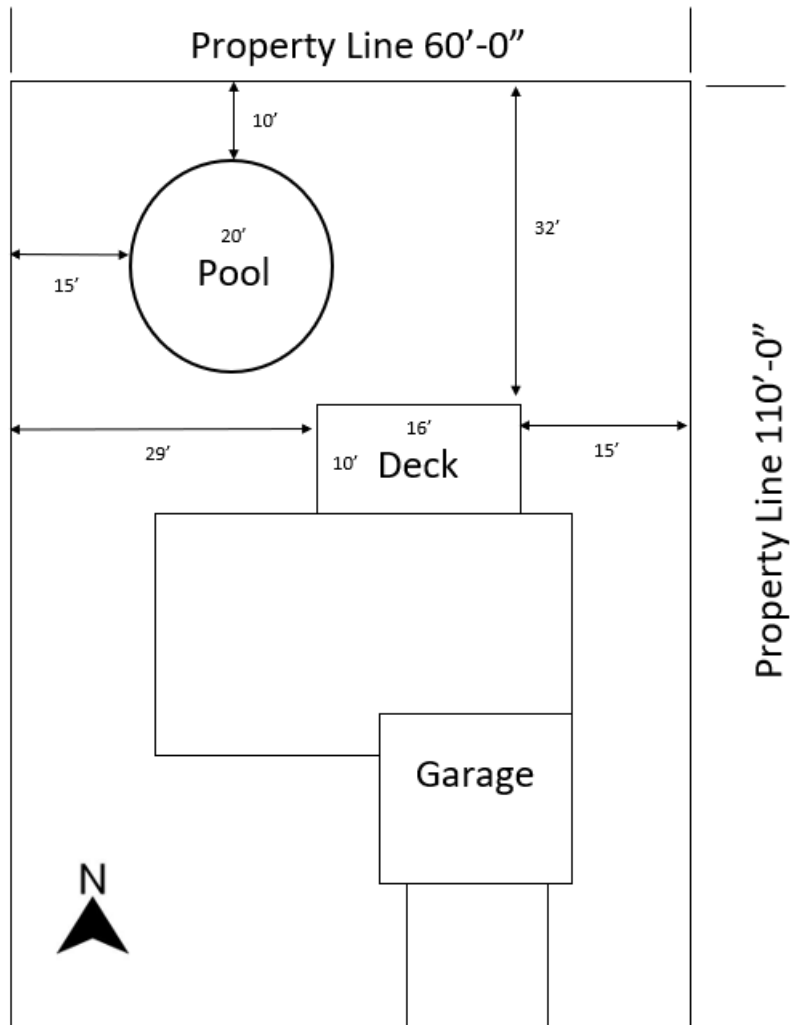

Fences & Barriers Example

A fence or solid structure of not less than (48) inches in height shall completely enclose the premises and / or swimming pool. Openings in the barrier shall not allow passage of a (4) inch diameter sphere.

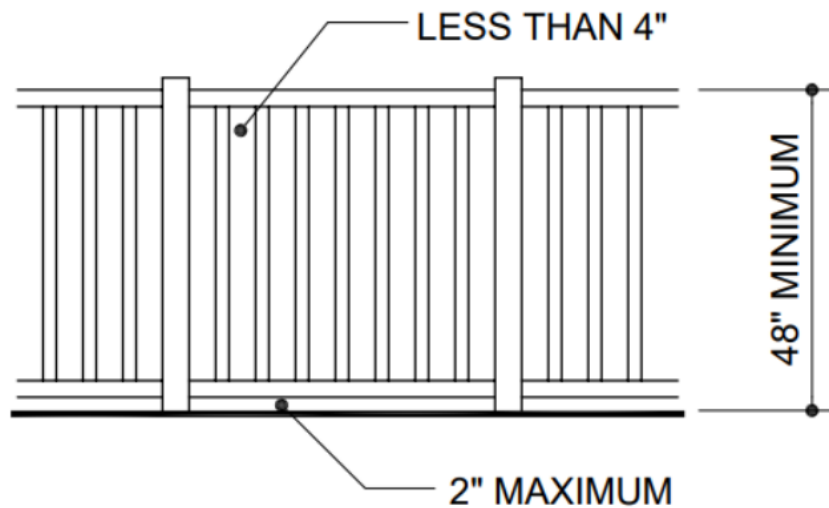

Pool Wall Height & Grade Example

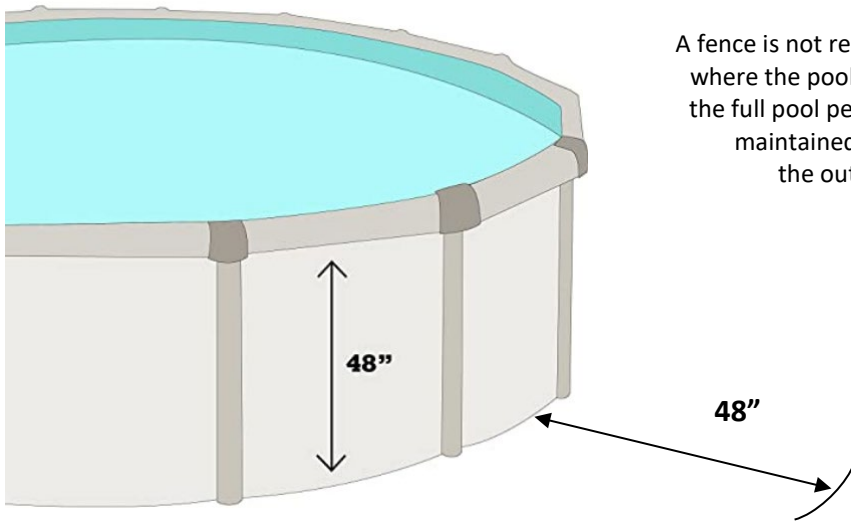

A fence is not required around an above ground pool where the pool wall is at least 48" above grade for the full pool perimeter. The finished grade shall be maintained for a minimum of 48" beyond the outside perimeter of the pool.

Gates & Doors Example

